

PRELIMINARY PLANS FOR A
LARGE SCALE DEVELOPMENT

SERVING

TALDO RENTALS LLC

**290 SOUTH BARRINGTON ROAD
 TONTITOWN, ARKANSAS**

CONTACT LIST	
ENGINEER	
ENGINEERING SERVICES, INC. 1207 SOUTH OLD MISSOURI RD. SPRINGDALE, AR 72764	
JASON APPEL: 479-751-8733	
BLACK HILLS ENERGY	
BRANDON STOKES: 479-225-3726	
AT&T	
JOHN HILL: 479-442-1936	
OZARKS ELECTRIC	
WES MAHAFFEY: 479-684-4949	
COX COMMUNICATION	
MICHAEL MOORE: 479-717-3730	
TONTITOWN WATER UTILITIES	
479-361-2700	
BUILDING DEPARTMENT	
479-361-2700	



INDEX OF SHEETS	
SHEET No.	DESCRIPTION
-	COVER
1	EXISTING CONDITIONS
2	LARGE SCALE DEVELOPMENT
3	STORM DRAINAGE PLAN
4	STORM DRAINAGE DETAILS
5	GRADING PLAN
6	PAVING & SIGNAGE PLAN
7	TYPICAL DETAILS
8	UTILITY PLAN
9-11	UTILITY DETAILS
12	LANDSCAPING PLAN
13	STORM WATER POLLUTION PROTECTION PLAN & DETAILS
14	LIGHTING PLAN

PRELIMINARY
 NOT FOR CONSTRUCTION

JASON APPEL, P.E. No. 13828
 ENGINEERING SERVICES, INC.

July 9, 2024

BY
ENGINEERING SERVICES INC.



CONSULTING ENGINEERS
 SPRINGDALE, ARKANSAS
 PHONE: 479-751-8733

FAX: 479-751-8746

WWW.ENGINEERINGSERVICES.COM

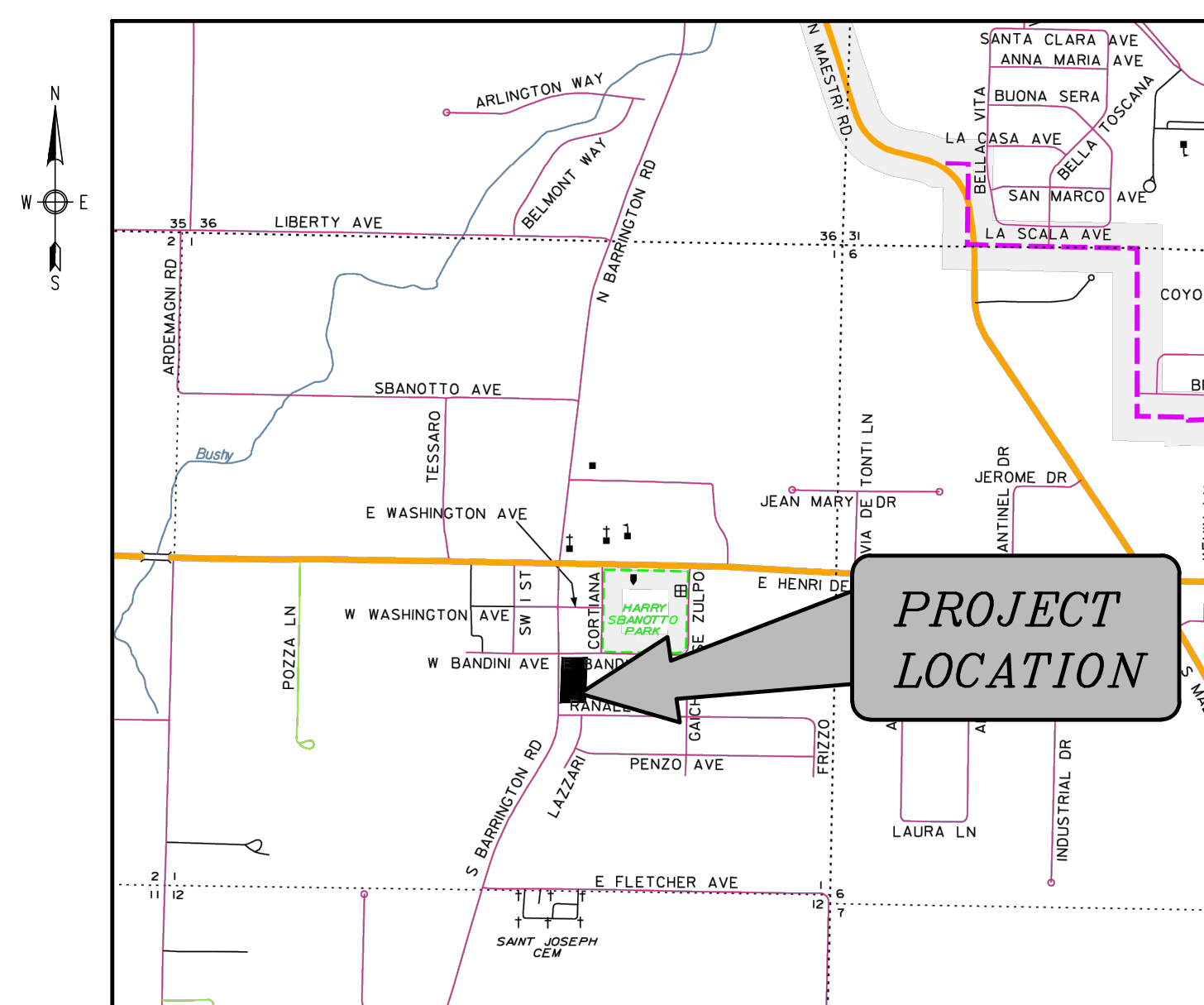

VICINITY MAP

NOTES:

- 1) ALL STREET AND DRAINAGE CONSTRUCTION MUST COMPLY WITH THE REQUIREMENTS OF THE CITY OF TONTITOWN, ARKANSAS.
- 2) ALL PUBLIC WATER AND SEWER CONSTRUCTION MUST COMPLY WITH THE CITY OF TONTITOWN STANDARD WATER & SEWER SPECIFICATIONS DATED JUNE 25, 2018.
- 3) TRAFFIC SAFETY CONTROL FEATURES ARE TO BE PROVIDED BY THE CONTRACTOR.
- 4) ANY STREET CLOSURES ARE TO BE COORDINATED WITH THE CITY OF TONTITOWN 48 HOURS PRIOR TO WORK.
- 5) THERE ARE NO KNOWN WETLANDS ON THIS PROPERTY.
- 6) NO KNOWN EROSION PROBLEMS EXIST ON THIS SITE.
- 7) NO KNOWN S.S. OVERFLOW PROBLEMS EXIST ON THIS SITE.
- 8) THERE ARE NO KNOWN EXISTING OR ABANDONED WATER WELLS, SUMPS, CESSPOOLS, SPRINGS, WATER IMPOUNDMENTS, OR UNDERGROUND STRUCTURES ON THIS PROPERTY.
- 9) THERE ARE NO KNOWN POTENTIALLY DANGEROUS AREAS.
- 10) THERE ARE NO KNOWN EXISTING OR PROPOSED GROUND LEASES OR ACCESS AGREEMENTS EXCEPT AS SHOWN.
- 11) THE SUBJECT PROPERTY IS WITHIN THE FLOOD PLAIN ZONE 'X', (NO SHADING) DESIGNATED AS AN AREA DETERMINED TO BE OUTSIDE OF 0.2% ANNUAL CHANCE FLOODPLAIN, AS SHOWN ON THE FEMA F.I.R.M. MAP #05143C0065F, EFFECTIVE DATE: APRIL 02, 2008.
- 12) ALL AMENITIES SHALL BE MAINTAINED BY THE SITE MANAGER.

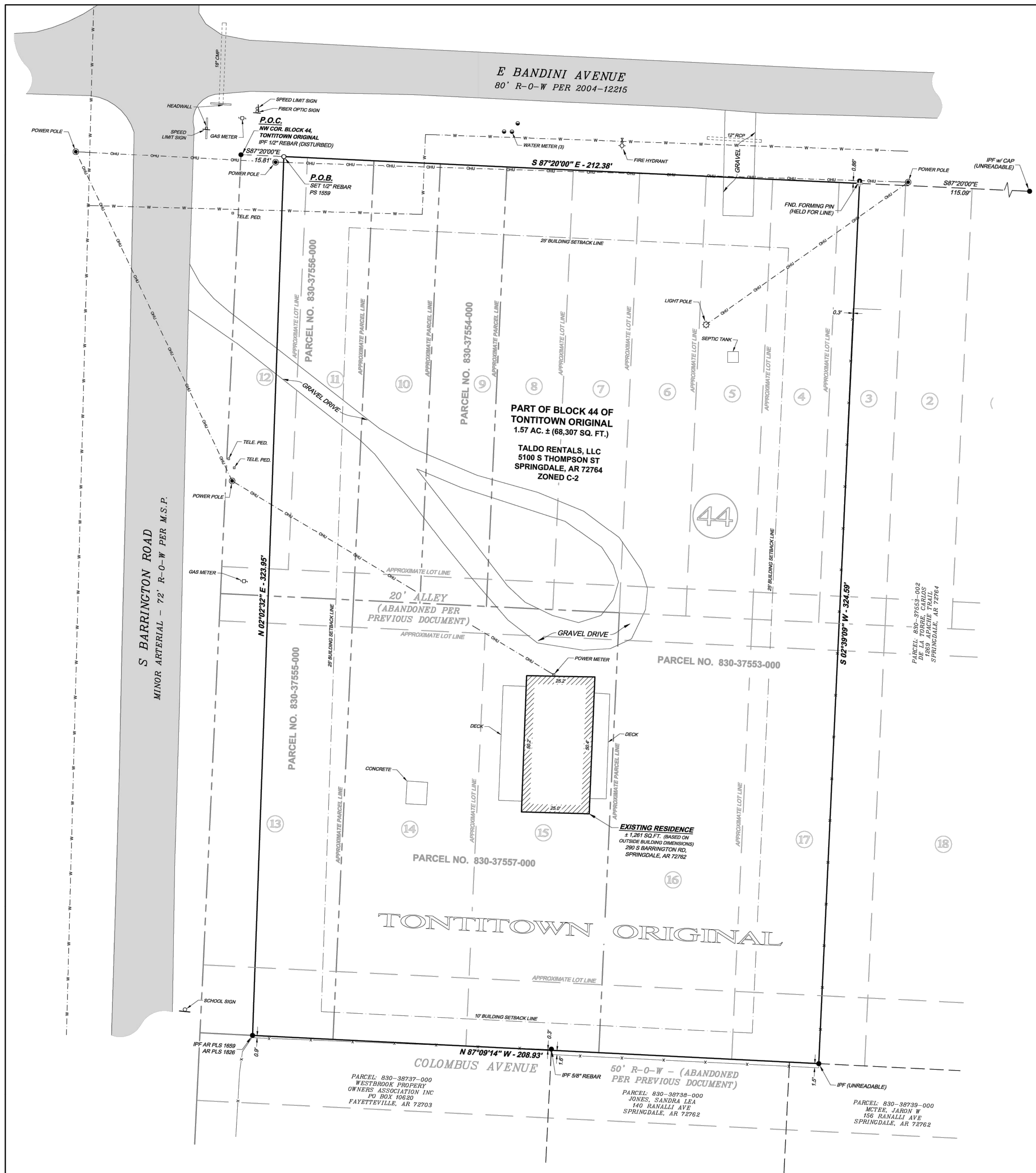

LEGEND

—	PROPERTY LINE	P.O.C.	POINT OF COMMENCEMENT
- - -	APPROXIMATE PARCEL LINE	P.O.B.	POINT OF BEGINNING
- · - · -	APPROXIMATE LOT LINE	●	IPF - IRON PIN FOUND (AS NOTED)
- · - · -	ADJACENT OWNER LINE	○	IPF - IRON PIN SET w/ CAP "PS 1559"
- · - · -	EASEMENT (AS NOTED)	+	COMPUTED POINT
- · - · -	BUILDING SETBACK LINE (B.S.L.)	⊕	WATER METER (WM)
- · - · -	FENCE LINE	⊕	FIRE HYDRANT (FH)
- · - · -	OVERHEAD UTILITIES	⊕	WATER VALVE (WV)
- · - · -	WATER LINE	⊕	GAS METER (GM)
- · - · -		⊕	POWER POLE (PP)

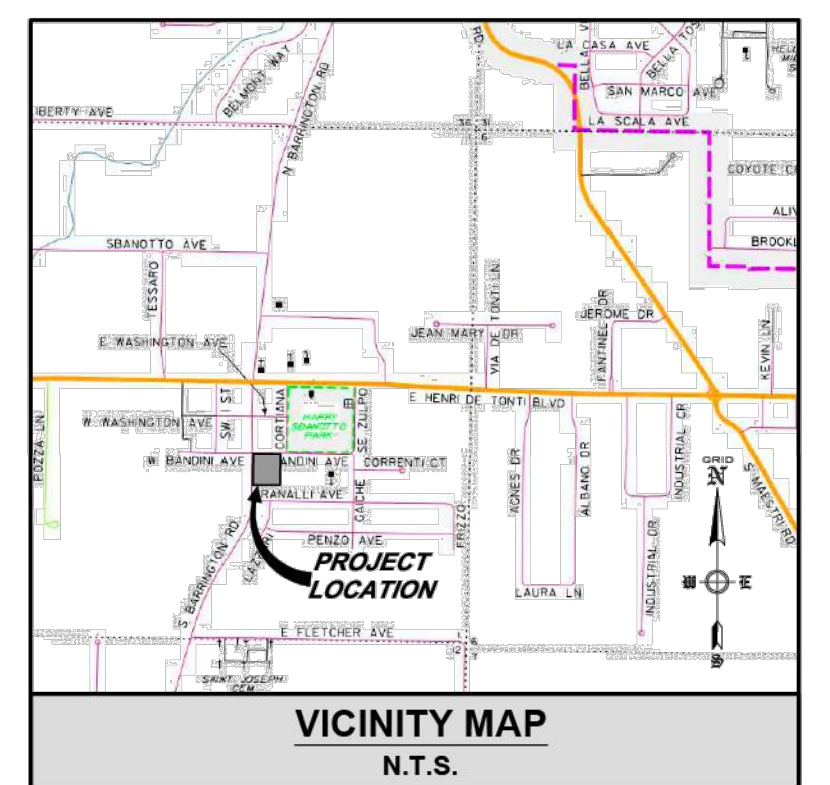
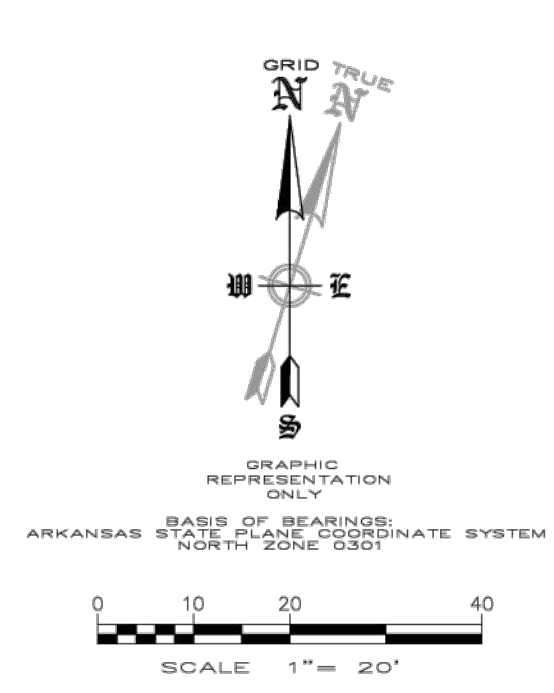

SURVEYOR'S NOTES:
THIS SURVEY IS VALID ONLY IF THE DRAWING INCLUDES THE ORIGINAL SEAL AND SIGNATURE OF THE SURVEYOR. THE ORIGINAL SIGNATURE, IF NOT BLUE IN COLOR, IS NOT VALID.

PLAT CLOSURE DECLARATION:
THIS PLAT HAS BEEN CALCULATED FOR CLOSURE AND IS FOUND TO BE ACCURATE TO WITHIN ONE FOOT IN 216,576 FEET.

FEMA FLOOD PLAIN ZONE:
THIS PROPERTY IS NOT WITHIN A FLOOD PLAIN ZONE AS SHOWN ON THE F.L.R.M. MAP # 05143C0065F, PANEL 65 OF 575, WASHINGTON COUNTY, ARKANSAS & INCORPORATED AREAS. MAP REVISED: MAY 16, 2008.

UTILITIES:
THE UTILITY INFORMATION, IF ANY SHOWN HEREON, WAS OBSERVED BY THE SURVEYOR ON-SITE AND IS BASED ON ABOVE GROUND UTILITY FEATURES AND CITY OF TONTITOWN G.I.S. ONLY.

THE DESIGNATIONS AND LOCATIONS OF THESE UTILITY FEATURES SHOWN HEREON ARE NOT TO BE CONSTRUED AS ALL INCLUSIVE OR ABSOLUTE AND ARE PROVIDED WITHOUT WARRANTY.

REFERENCES:
EVERY DOCUMENT OF RECORD REVIEWED AND CONSIDERED AS A PART OF THIS SURVEY IS NOTED BELOW. THE SURVEYOR RESEARCHED OR WAS PROVIDED NECESSARY DEEDS, RIGHT-OF-WAY MAPS, AND OTHER PERTINENT INFORMATION AS SHOWN BELOW. THE SURVEYOR HAS MADE NO INVESTIGATION OR INDEPENDENT SEARCH FOR COURT CASE DECREES, ADVERSE POSSESSION CLAIMS, SUBSURFACE RIGHTS OR OWNERSHIP, ENCUMBRANCES, OR RESTRICTIVE COVENANTS.

ALL RECORDS LISTED BELOW ARE IN THE OFFICE OF THE CIRCUIT CLERK AND EX-OFFICIO RECORDER OF WASHINGTON COUNTY, ARKANSAS UNLESS OTHERWISE NOTED.

- WARRANTY DEED: TALDO RENTALS, LLC, RECORDED MAY 21, 2021, FILE NO. 2021-19337.
- BOUNDARY SURVEY: BY BLEW & ASSOCIATES, PA, W. GAGNER, AR PLS NO. 1659, RECORDED JUNE 1, 2021, FILE NO. 2021-20493.
- SURVEY: BY ALAN REID & ASSOCIATES, G. ALAN REID, AR PLS NO. 1005, RECORDED APRIL 2, 2004, FILE NO. 2004-12215.
- ORIGINAL PLAT OF TONTITOWN: RECORDED JUNE 16, 1998, BOOK 3 PAGE 415.
- ORIGINAL PLAT OF TONTITOWN: RECORDED DECEMBER 2, 1909, BOOK 4 PAGES 55 AND 56.
- WARRANTY DEED: LEONARD & VICKI CEOLA, RECORDED JULY 30, 1996, FILE 96-47371.

SURVEY DESCRIPTION - PARCELS 830-37556-000, 830-37555-000, 830-37554, 830-37553-000 AND 830-37557-000:
PART OF BLOCK 44 OF TONTITOWN ORIGINAL, CITY OF TONTITOWN, AS RECORDED IN THE WASHINGTON COUNTY, ARKANSAS RECORDS AS PLAT FILE 4-55, ALSO A RESURVEY FILED AS PLAT FILE 3-415 OF THE WASHINGTON COUNTY, ARKANSAS RECORDS, AND BEING MORE PARTICULARLY DESCRIBED AS FOLLOWS:
COMMENCING AT THE NORTHWEST CORNER OF SAID BLOCK 44, SAID POINT BEING A FOUND 1/2 INCH REBAR; THENCE ALONG THE NORTH LINE OF SAID BLOCK 44, S87°20'00" E A DISTANCE OF 15.81 FEET TO THE POINT OF BEGINNING; SAID POINT BEING A SET IRON PIN WITH CAP "PS 1559" ON THE EASTERLY RIGHT-OF-WAY LINE OF SOUTH BARRINGTON ROAD; THENCE CONTINUING ALONG SAID NORTH LINE, S87°20'00" E A DISTANCE OF 212.38 FEET TO A POINT FROM WHICH FALLS A FOUND "FORMING PIN" N02°39'09" E A DISTANCE OF 0.86 FEET; THENCE LEAVING SAID NORTH LINE, S02°39'09" W A DISTANCE OF 324.59 FEET TO A FOUND IRON PIN WITH CAP (UNREADABLE); THENCE N87°09'14" W A DISTANCE OF 208.93 FEET TO A FOUND IRON PIN WITH CAP "AR PLS 1659 AR PLS 1626" ON THE EASTERLY RIGHT-OF-WAY LINE OF SOUTH BARRINGTON ROAD; THENCE ALONG SAID EASTERLY RIGHT-OF-WAY LINE, N02°02'32" E A DISTANCE OF 323.95 FEET TO THE POINT OF BEGINNING AND CONTAINING 1.57 ACRES (68,307 SQUARE FEET), MORE OR LESS, AND SUBJECT TO ALL EASEMENTS, RIGHTS-OF-WAY AND RESTRICTIVE COVENANTS OF RECORD AND FACT.

SURVEYOR'S DECLARATION:
I HEREBY DECLARE THAT I HAVE THIS DAY COMPLETED A SURVEY OF THE ABOVE DESCRIBED PROPERTY. THE PROPERTY LINES AND CORNER MONUMENTS ARE TO THE BEST OF MY KNOWLEDGE AND ABILITY, CORRECTLY ESTABLISHED, AND THERE ARE NO ENCROACHMENTS EXCEPT AS SHOWN ON THIS PLAT. I FURTHER DECLARE THAT THIS SURVEY MEETS THE CURRENT "MINIMUM STANDARDS FOR PROPERTY BOUNDARY SURVEYS" PER THE STATE OF ARKANSAS.

Rodney Woods 4/6/23
RODNEY WOODS, P.S. NO. 1559, AR. DATE



OWNER: TALDO RENTALS, LLC
5100 S THOMPSON ST
SPRINGDALE, AR 72764

SURVEYOR: ENGINEERING SERVICES, INC.
1207 S. OLD MISSOURI ROAD
P.O. BOX 282
SPRINGDALE, AR 72765

WORK ORDER #: 23915

CITY ZONING: C-2 (GENERAL COMMERCIAL)

SETBACKS: FRONT - 25'
STREET SIDE - 25'
SIDE - 10'
REAR - 25'

PLAT CODE: 500-17N-31W-0-01-240-72-1559

REVISION	DATE	DESCRIPTION

BOUNDARY SURVEY
FOR TALDO RENTALS, LLC
TONTITOWN, WASHINGTON COUNTY, ARKANSAS
SCALE: 1"=20' DATE: April 6, 2023 DRAWN BY:KND/RER
ENGINEERING SERVICES, INCORPORATED
SPRINGDALE, ARKANSAS

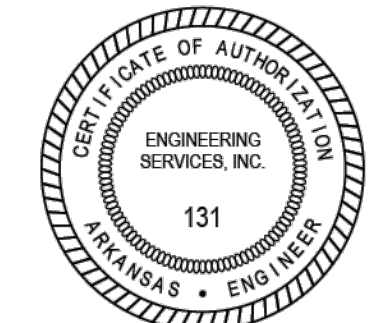

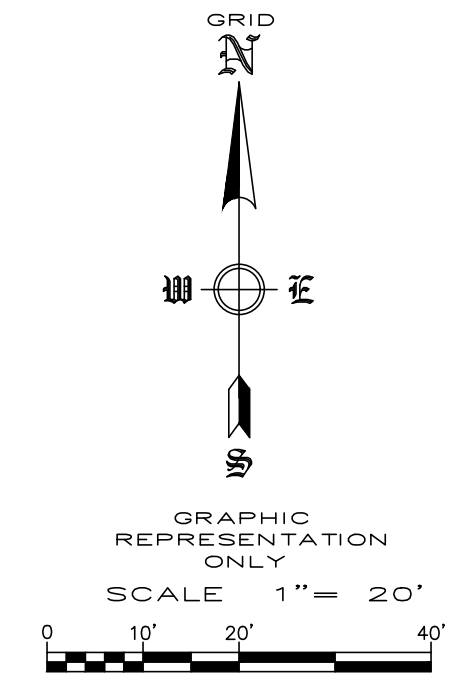
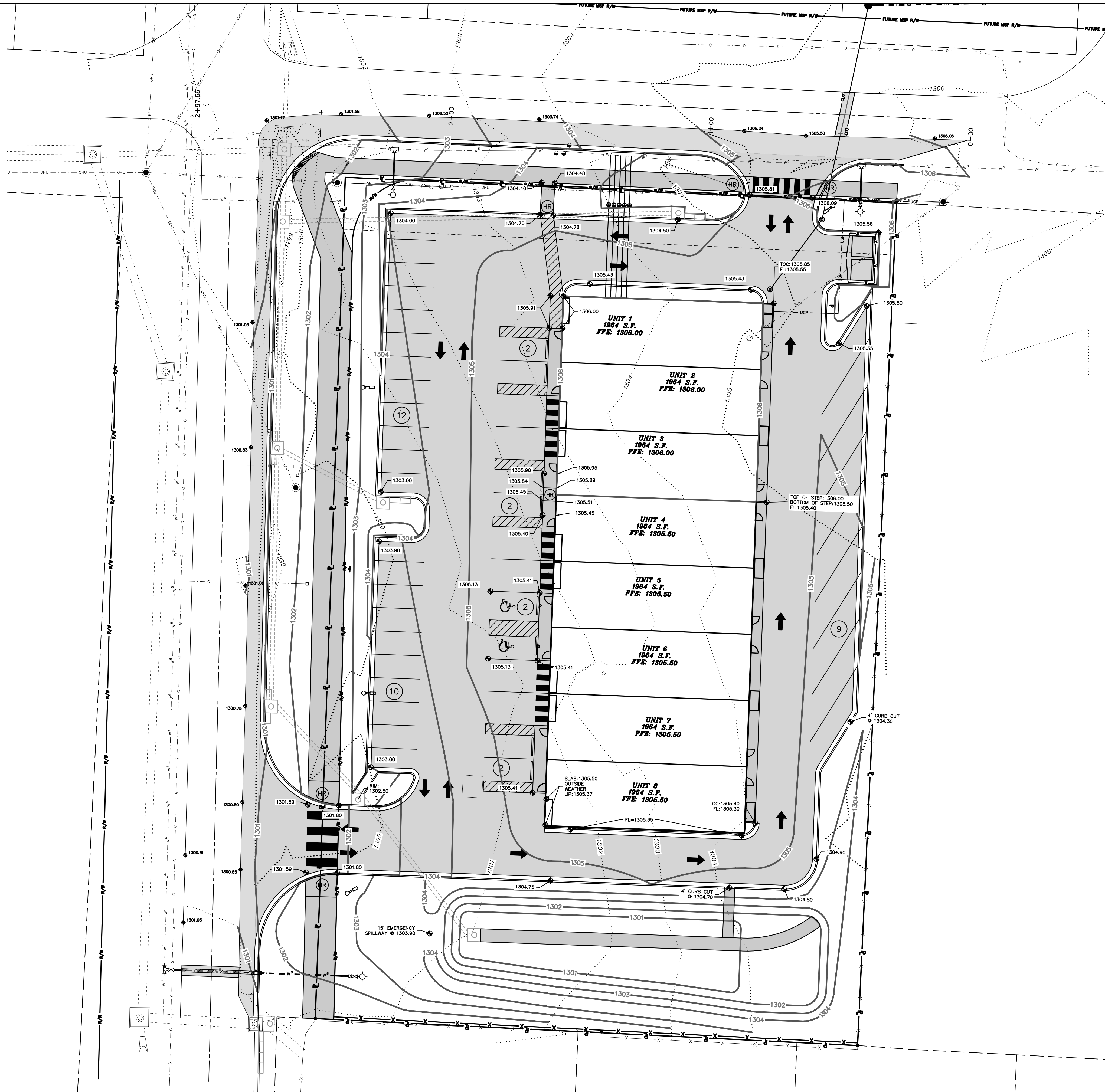

*ALL SPOT ELEVATIONS ARE THE FLOWLINE OF THE GUTTER UNLESS OTHERWISE NOTED.

LEGEND	
●	IRON PIN FOUND
○	IRON PIN SET
---	PROPERTY LINE
- - - - -	EX. EASEMENT LINE
- - - - -	EX. BUILDING SETBACK LINE
- - - - -	EX. ROAD CENTERLINE
- - - - -	EX. CURB & GUTTER
---	EX. WATER LINE
- - - - -	EX. 8" SEWER LINE
- - - - -	EX. STORM DRAIN LINE
- - - - -	EX. OVERHEAD POWER LINE
- - - - -	EX. FIBER OPTIC LINE
○	EX. WATER METER
○	EX. FIRE HYDRANT
○	EX. SEWER MANHOLE
○	EX. POWER POLE
○	EX. WATER VALVE
○	EX. LIGHT POLE
○	EX. WATER METER
○	EX. CONTOUR
---	PROPOSED CONTOUR
- - - - -	PROPOSED FENCE
- - - - -	PROPOSED EASEMENT LINE
- - - - -	PROPOSED BUILDING SETBACK LINE
- - - - -	PROPOSED CURB & GUTTER
○	PROPOSED FIRE HYDRANT
- - - - -	PROPOSED WATERLINE
- - - - -	PROPOSED SEWER MANHOLE & PIPE
○	PROPOSED SINGLE WATER SERVICE
○	PROPOSED DOUBLE WATER SERVICE
○	PROPOSED SEWER SERVICE
○	PROPOSED LIGHT POLE
○	PROPOSED HANDICAP RAMP
○	PROPOSED STORM BOX & PIPE



GRADING PLAN
TALDO BARRINGTON COMMERCIAL
290 BARRINGTON ROAD
TONITOWN, ARKANSAS

REVISION	DATE	DESCRIPTION

SCALE: 1"=20"
 DATE: Apr 19, 2024
 ENGINEER: JIA
 DRAWN BY: HMB
 W.O. #: 23915

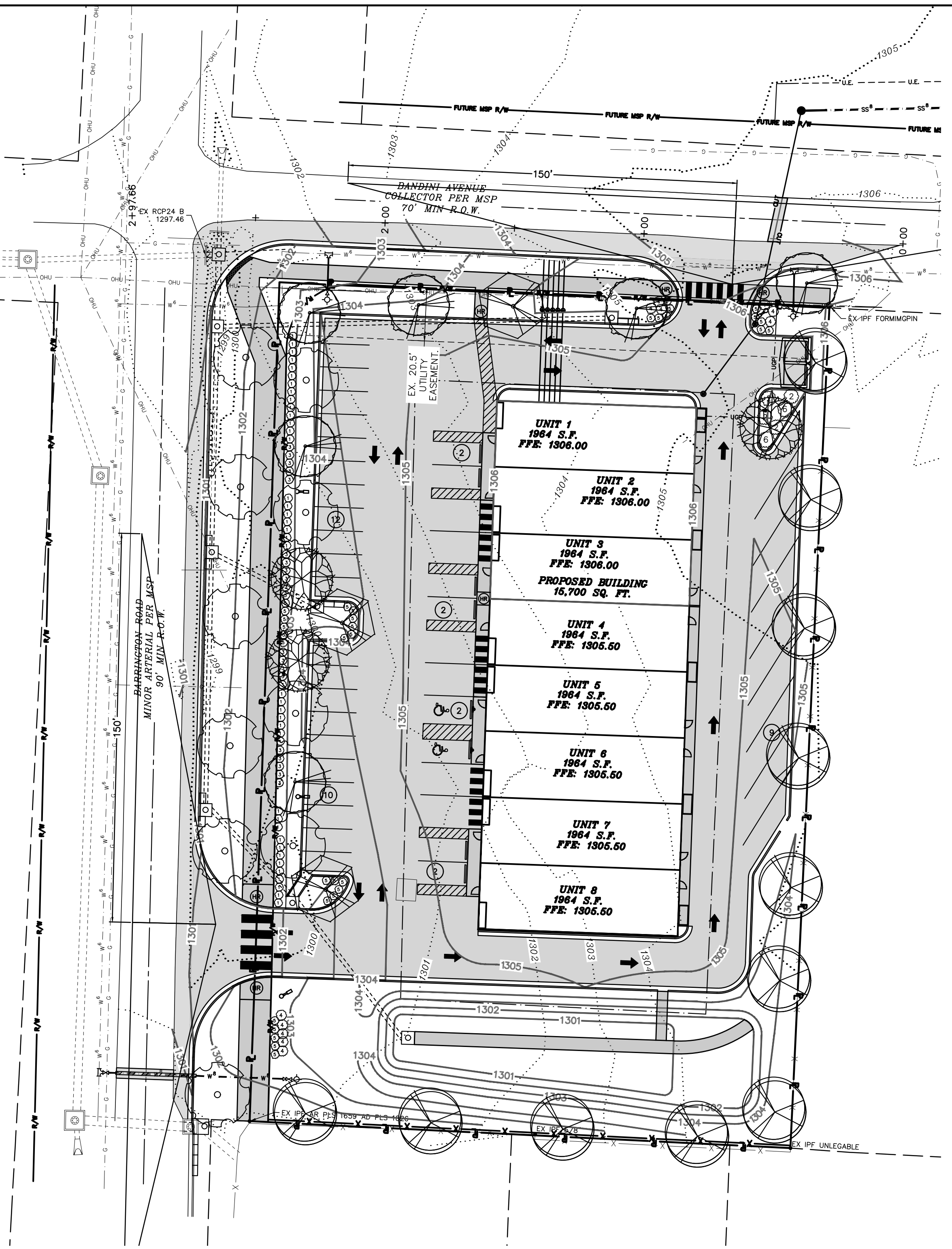

INDEX OF TREES					
TREE SYMBOL	COMMON NAME	BOTANICAL NAME	TOTAL # TREES	SIZE	MATURE HEIGHT
	Legacy Sugar Maple	Acer saccharum 'Legacy'	10	2.5" Cal B & B	55'-65'
	Valley Forge American Elm	Ulmus Americana 'Valley Forge'	6	2.5" Cal B & B	55'-65'
	Oklahoma Redbud	Cercis canadensis 'Oklahoma'	3	2.5" Cal B & B	15'-20'
	Hightower Willow Oak	Quercus phellos 'Hightower'	4	2.5" Cal B & B	60'-65'
	Northern Red Oak	Quercus rubra	11	2.5" Cal B & B	60'-65'

INDEX OF SHRUBS					
SYMBOL	COMMON NAME	BOTANICAL NAME	TOTAL # PLANTS	SIZE	
①	Compact Inkberry Holly	Ilex glabra 'Compacta'	40	3 GAL	
②	Little Henry Dwarf Sweetspire	Itea virginica 'Sprich'	3	3 GAL	
③	Kaleidoscope Abelia	Abelia x grandiflora 'Kaleidoscope'	20	3 GAL	
④	Youngstown Andorra Juniper	Juniperus horizontalis 'Youngstown'	11	3 GAL	
⑤	Red Drift Groundcover Rose	Rosa hybrid 'Meigalpio'	34	3 GAL	
⑥	Karly Rose Fountain Grass	Pennisetum orientale 'Karly Rose'	2	1 GAL	

LANDSCAPE NOTES:

- IRRIGATION SYSTEM OR HOSE BIBS SHALL BE PROVIDED FOR ALL LANDSCAPED AREAS AND WILL CONFORM TO CITY OF TONTOWN REQUIREMENTS.
- SOIL SHALL BE AMENDED AND ALL ROCKS AND FOREIGN MATERIAL SHALL BE REMOVED PRIOR TO ANY LANDSCAPE INSTALLATION, ANY PROPOSED PLANTING AREAS COVERED BY GRASS SHALL HAVE THE SOD COMPLETELY REMOVED BEFORE PLANTING BEGINS.
- ALL PLANTING BEDS SHALL RECEIVE 12" OF TOPSOIL FREE OF ROCKS/WEEDS/DEBRIS PRIOR TO INSTALLATION OF PLANT MATERIAL.
- ALL PLANTING BEDS SHALL RECEIVE ORGANIC MULCH AT TIME OF INSTALLATION. MULCH SHALL NOT BE PLACED IMMEDIATELY ADJACENT TO TRUNK, AND SHALL BE KEPT AT LEAST 3" FROM THE ROOT COLLAR AT THE SOIL LINE.
- ALL PLANTING BEDS SHALL BE CONTAINED BY EDGING OR MATERIAL OTHER THAN VEGETATION/SOD.
- SHADE TREES SHALL HAVE A MIN. CALIPER OF 3" AND A HEIGHT OF 8'
- ALL PLANTS SHALL BE HEALTHY, VIGOROUS, AND FREE OF PESTS AND DISEASE.
- ALL PLANT MATERIAL IS SUBJECT TO THE APPROVAL OF THE LANDSCAPE ARCHITECT BEFORE, DURING, AND AFTER CONSTRUCTION.
- THE CONTRACTOR IS RESPONSIBLE FOR FULLY MAINTAINING ALL PLANTING MATERIAL (INCLUDING BUT NOT LIMITED TO: WATERING, SPRAYING, MULCHING, FERTILIZING, ETC.) IN ALL PLANTING AREAS AND LAWN UNTIL THE WORK IS ACCEPTED IN TOTAL BY THE OWNER.
- ONCE INSTALLED LANDSCAPING SHALL BE MAINTAINED IN A HEALTHY LIVING CONDITION, AND IF PLANT MATERIAL DIES IT SHALL BE REPLACED PROMPTLY, OR IF DURING INHOSPITABLE PLANTING CONDITIONS, WITHIN THE NEXT APPROPRIATE GROWING SEASON.
- IF CONFLICTS WITH PROPOSED LIGHTS, FIRE HYDRANTS, OR OTHER SITE FEATURES EXIST, TREES OR SHRUBS SHALL BE MOVED AND SHALL NOT INTERFERE WITH PROPOSED FEATURES.
- MAINTAIN 5' MINIMUM HORIZONTAL SEPARATION BETWEEN TREE PLANTING AND UTILITY LINES.
- LANDSCAPING SHALL BE GUARANTEED FOR A PERIOD OF 2 YEARS FROM DATE OF ACCEPTANCE.
- ANY AREAS DISTURBED BY CONSTRUCTION ACTIVITY TO BE SODDED AND RE-VEGETATED WITH BERMUDA MIX WHICH IS CERTIFIED FREE FROM WEED SEEDS.

INTERIOR SITE LANDSCAPING REQUIREMENTS:

SHRUBS TO SPAN A MINIMUM OF 25% OF THE BUILDING FRONTAGE.
SPAN OF SHRUBS ALONG FRONTAGE PROVIDED = 32%

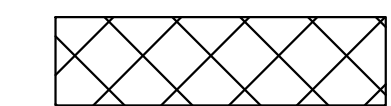

PERIMETER LANDSCAPING REQUIREMENTS:

TOTAL PERIMETER LF: 515 LINEAR. FT.
TOTAL PERIMETER LANDSCAPE REQUIRED:
2 SMALL TREES OR ONE LARGE TREE PER 50' = 10 LARGE TREES OR 20 SMALL TREES
TOTAL PERIMETER LANDSCAPE PROVIDED:
11 LARGE TREES

STREET FRONTAGE LANDSCAPING REQUIREMENTS:

TOTAL FRONTAGE LF: 230 LINEAR. FT. (BARRINGTON)
175 LINEAR FT. (BANDINI)
TOTAL FRONTAGE LANDSCAPE REQUIRED:
1 TREE PER 50' = 9 TREES
TOTAL FRONTAGE LANDSCAPE PROVIDED: 9 TREES

LANDSCAPE PARKING REQUIREMENTS:

1 PARKING ISLAND REQUIRED PER 15 PARKING SPACES
46 PARKING SPACES / 15 = 3 PARKING ISLANDS REQUIRED
TOTAL PARKING ISLANDS PROVIDED: 3
1 LARGE TREE PER PARKING ISLAND = 3 LARGE TREES
LARGE TREES PROVIDED = 3

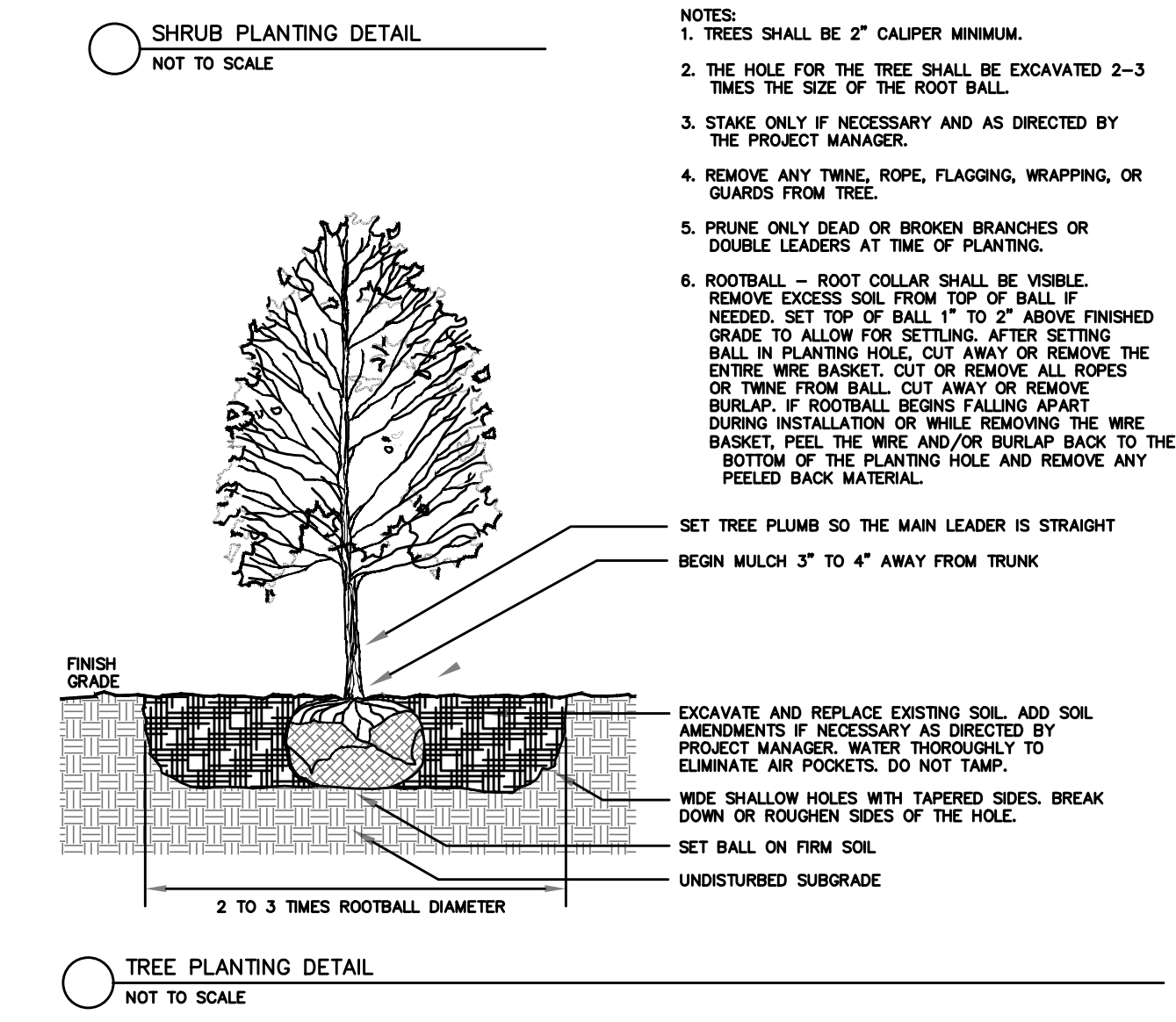
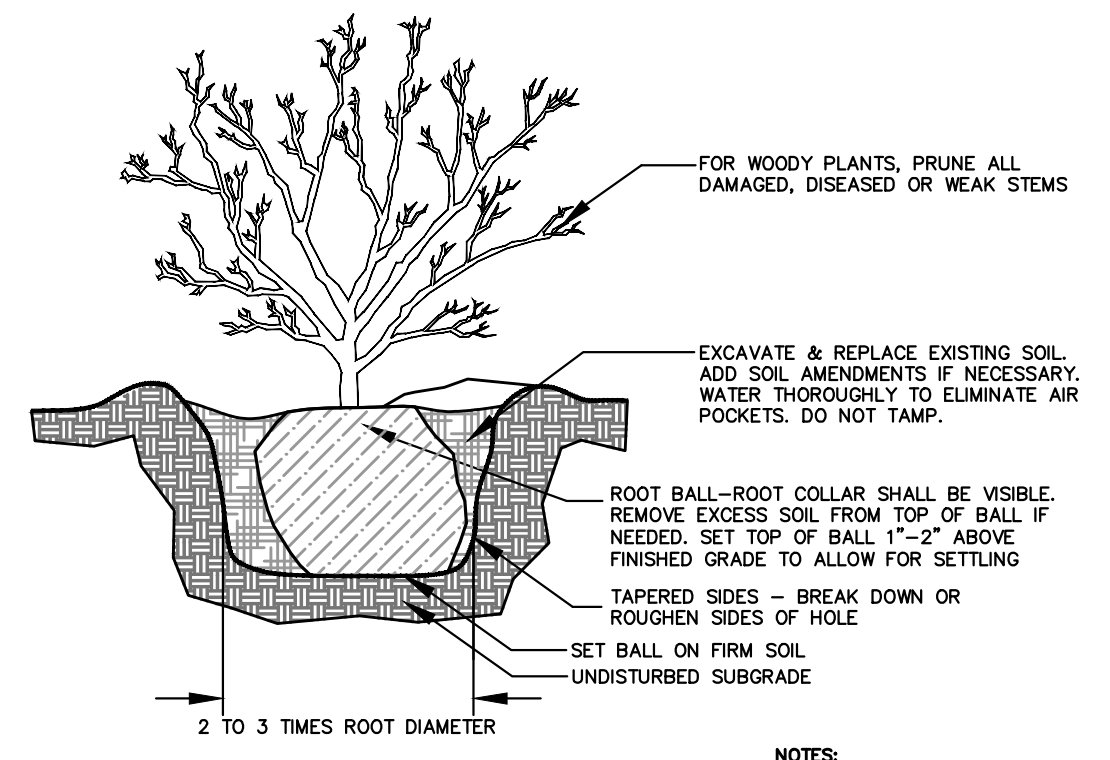

- NOTES:**
- TREES SHALL BE 2" CALIPER MINIMUM.
 - THE HOLE FOR THE TREE SHALL BE EXCAVATED 2-3 TIMES THE SIZE OF THE ROOT BALL.
 - STAKE ONLY IF NECESSARY AND AS DIRECTED BY THE PROJECT MANAGER.
 - REMOVE ANY TWINE, ROPE, FLAGGING, WRAPPING, OR GUARDS FROM TREE.
 - PRUNE ONLY DEAD OR BROKEN BRANCHES OR DOUBLE LEADERS AT TIME OF PLANTING.
 - ROOTBALL - ROOT COLLAR SHALL BE VISIBLE. REMOVE EXCESS SOIL FROM TOP OF BALL IF NEEDED. SET TOP OF BALL 1" TO 2" ABOVE FINISHED GRADE TO ALLOW FOR SETTLING. AFTER SETTING BALL IN PLANTING HOLE, CUT AWAY OR REMOVE THE ENTIRE WIRE BASKET, CUT AWAY OR REMOVE ALL ROPES OR TWINE FROM BALL, CUT AWAY OR REMOVE BURLAP. IF ROOTBALL BEGINS FALLING APART DURING INSTALLATION OR WHILE REMOVING THE WIRE BASKET, PEEL THE WIRE AND/OR BURLAP BACK TO THE BOTTOM OF THE PLANTING HOLE AND REMOVE ANY PEELLED BACK MATERIAL.



REVISION	DATE	DESCRIPTION

SCALE: 1"=30'
DATE: Jul 9, 2024
ENGINEER: JSA
DRAWN BY: CAS
W.O. #: 23915

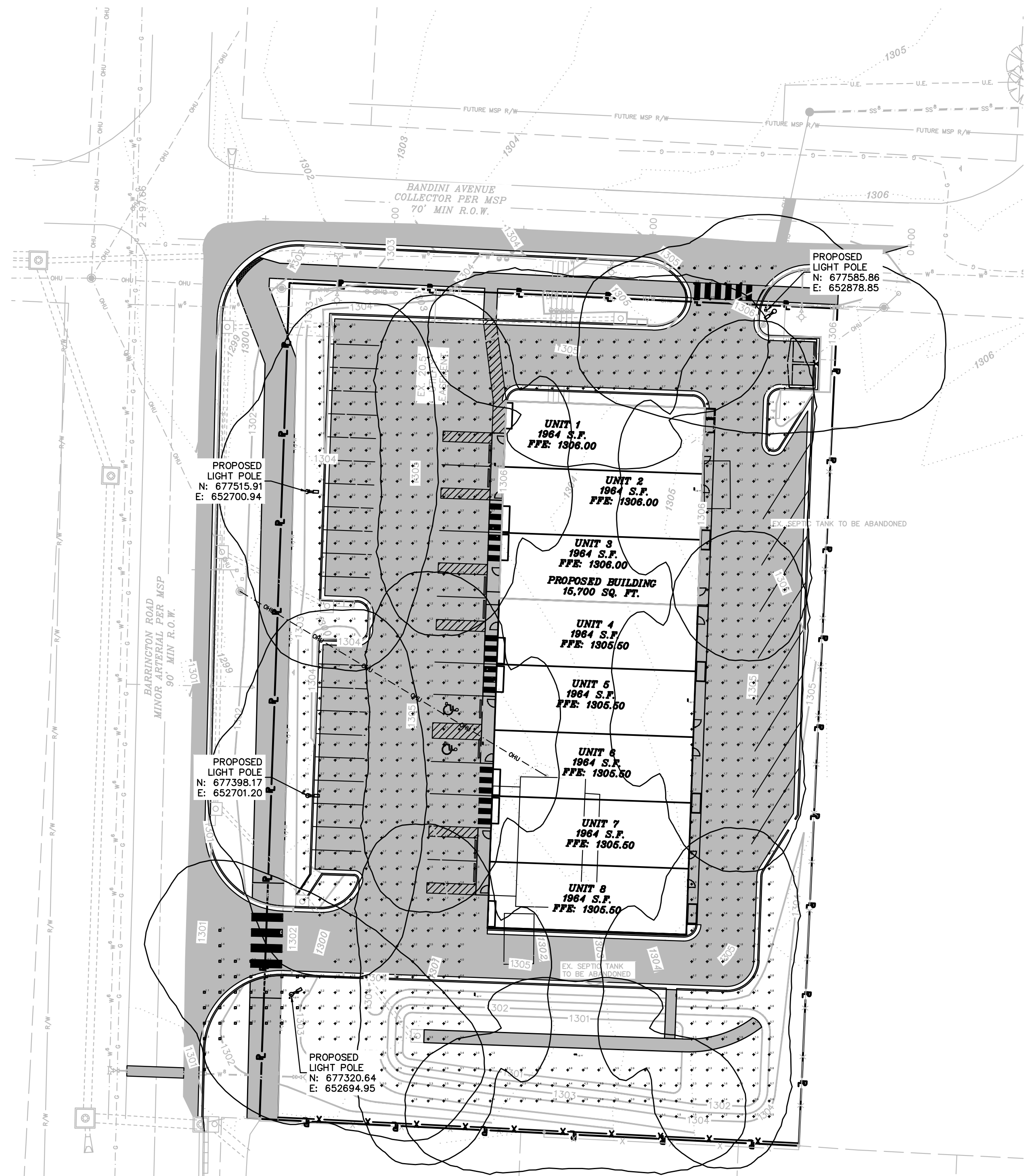

Symbol	Label	Image	Quantity	Manufacturer	Catalog Number	Description	Number Lamps	Lumens Per Lamp	Light Loss Factor	Wattage	Plot
□	B		4	American Electric Lighting	ACM P605 R3 4K/5K	ACM P605 Performance package Roadway Type III distribution 4000K/5000K CCT	1	13092	0.9	84	
□	C		8	Holophane	HLWPC2 P50 40K XX T3M	Wallpack Full Cutoff LED, LED Performance Package P20, 4000 series CCT, Voltage, Type III Medium	1	11399	0.9	115	

Description	Symbol	Avg	Max	Min	Max/Min	Avg/Min
North Drive	◇	2.3 fc	3.3 fc	0.9 fc	3.7:1	2.6:1
Site Lighting	+	2.1 fc	6.5 fc	0.4 fc	16.3:1	5.3:1
West Drive	□	1.8 fc	2.8 fc	0.2 fc	14.0:1	9.0:1

AEL American Electric Lighting
Submittal Spec Sheet
 Dynamically Generated
 Series: ACM
 Date: 9/7/2023
 Project: _____
 Group/Type: _____
 Qty: 0

AutoConnect ACM
 Medium Roadway Cobra Head
 Product Submittal Description:
 AutoConnect Intermediate Series, 12800 Lumens, 84 watts, 120-277V, 0-10V dimmable driver, Roadway Type III, 2-bolt internal, 4000K, Black, 10K/5A MOV pack, 7-pin photocell receptacle. No bottom receptacle. Shorting cap

Product Webpage: www.aaculbrands.com/products/detail/1790559
 Warranty: www.aaculbrands.com/support/warranty/terms-and-conditions

Model #: **ACM P605 MVOLT ZT R3 2B 4K BK MP PT NBR SH** ✓

Series*	Performance Package*	Voltage*
ACM AutoConnect Intermediate Series	P601 1400 Lumens, 41 watts P602 1800 Lumens, 57 watts P603 1910 Lumens, 67 watts P604 1900 Lumens, 68 watts P605 1900 Lumens, 61 watts P606 11000 Lumens, 71 watts P607 13000 Lumens, 84 watts P608 14100 Lumens, 94 watts	120/277V 120/277V 120/277V 120/277V 120/277V 120/277V 120/277V 120/277V

Fixture Driver*	Distribution*	Bolt Mounting*	Color Temperature*
D4 D4 Driver D7 5.10 Dimmable driver	R2 Roadway Type II R3 Roadway Type III R4 Roadway Type IV R5 Roadway Type V	B2 2-bolt Internal B3 4-bolt Internal	27K 2700K 30K 3000K 40K 4000K 50K 5000K

Finish*	Surge Protection*	Bubble Level
BK Black BCKR Black, 10K hour salt spray BZ Bronze BCKR Bronze, 10K hour salt spray GR Green GRCKR Green, 10K hour salt spray GY Gray GRCKR Gray, 10K hour salt spray WH White	SPK 20kV/10kA series SP 10kV/5kA MOV pack	SL Bubble level

One Lithonia Way Corvallis, GA 30012 • Phone: 800-705-7378 • www.aaculbrands.com
 © 2023 Acuity Brands Lighting, Inc. All rights reserved. Created Date: 9/7/2023 11:31 AM Page 1 of 2

HOLOPHANE
Submittal Spec Sheet
 Dynamically Generated
 Series: HLWPC2

HLWPC2 Wallpack
 Wallpack® Full Cutoff for Wall and Canopy Lighting
 Product Submittal Description:
 Wallpack FCO LED, 11,700 Lumens, 4000K, Type III medium, 120-277V, Black super durable paint, 7-pin NEMA photocell receptacle (photocell not included), Shorting cap

Product Webpage: www.aaculbrands.com/products/detail/1313571
 Warranty: www.aaculbrands.com/support/warranty/terms-and-conditions

Model #: **HLWPC2 P50 40K T3M MVOLT BKSDP PRT SH** ✓

Series*	Performance Package*	Color Temperature*	CRI
HLWPC2 Wallpack FCO LED	P10 3,100 Lumens P15 5,600 Lumens P20 7,800 Lumens P30 9,900 Lumens P50 11,700 Lumens	30K 3000K 40K 4000K 50K 5000K AMB True color	80/80 80/80

Additional Circuits	Distribution*	Voltage*	Surge Protection
D3 2 independent circuits	400F Type III medium offset 500F Type V offset T3M Type III medium T3S Type III offset T3M Type III medium T3S Type III offset T3M Type III medium T3S Type III offset T3M Type III medium T3S Type III offset	120 208 240 277 347 480 540/240V 540/240V 540/240V 540/240V	SPK 20K 10K

Finish*	Photocell Receptacle	Fasting	Temperature
BKSDP Black super durable paint BCKSDP Bronze super durable paint GRSDP One super durable paint GRCKSDP White super durable paint	P10 7-pin NEMA photocell receptacle (photocell not included) P15 7-pin NEMA photocell receptacle (photocell not included) P20 7-pin NEMA photocell receptacle (photocell not included) P30 7-pin NEMA photocell receptacle (photocell not included) P50 7-pin NEMA photocell receptacle (photocell not included)	SP Quick fast SF Single fast	T55 Tamper resistant cover

One Lithonia Way Corvallis, GA 30012 • Phone: 800-705-7378 • www.aaculbrands.com
 © 2023 Acuity Brands Lighting, Inc. All rights reserved. Created Date: 9/7/2023 11:38 AM Page 1 of 2

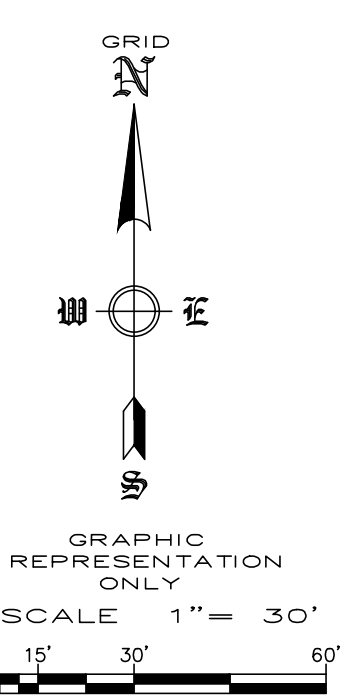

LIGHTING PLAN
TALDO BARRINGTON COMMERCIAL
290 BARRINGTON ROAD
TONITOWN, ARKANSAS

REVISION	DATE	DESCRIPTION

SCALE: 1" = 30"
 DATE: Jul 9, 2024
 ENGINEER: JA
 DRAWN BY: CAS
 W.O. #: 23915